

**DOCTOR'S OFFICE  
 TENANT BUILD-OUT**  
**JEWETT ORTHOPAEDIC CLINIC-  
 UCF BRANCH OFFICE**  
**3451 TECHNOLOGICAL AVE.  
 ORANGE CO., FLORIDA**  
 FOR:  
**JEWETT ORTHOPAEDIC CLINIC**  
**1285 ORANGE AVE.**  
**WINTER PARK, FLORIDA**

General Notes

Project No: 324J3 Approv. By: **RLB**  
 Drawn By: **RLB** Date: 6/11/04  
 Checked By: **RLB** Scale: **NOTED**

**PROPOSED  
 FLOOR PLAN**

Sheet No:

**A-2**

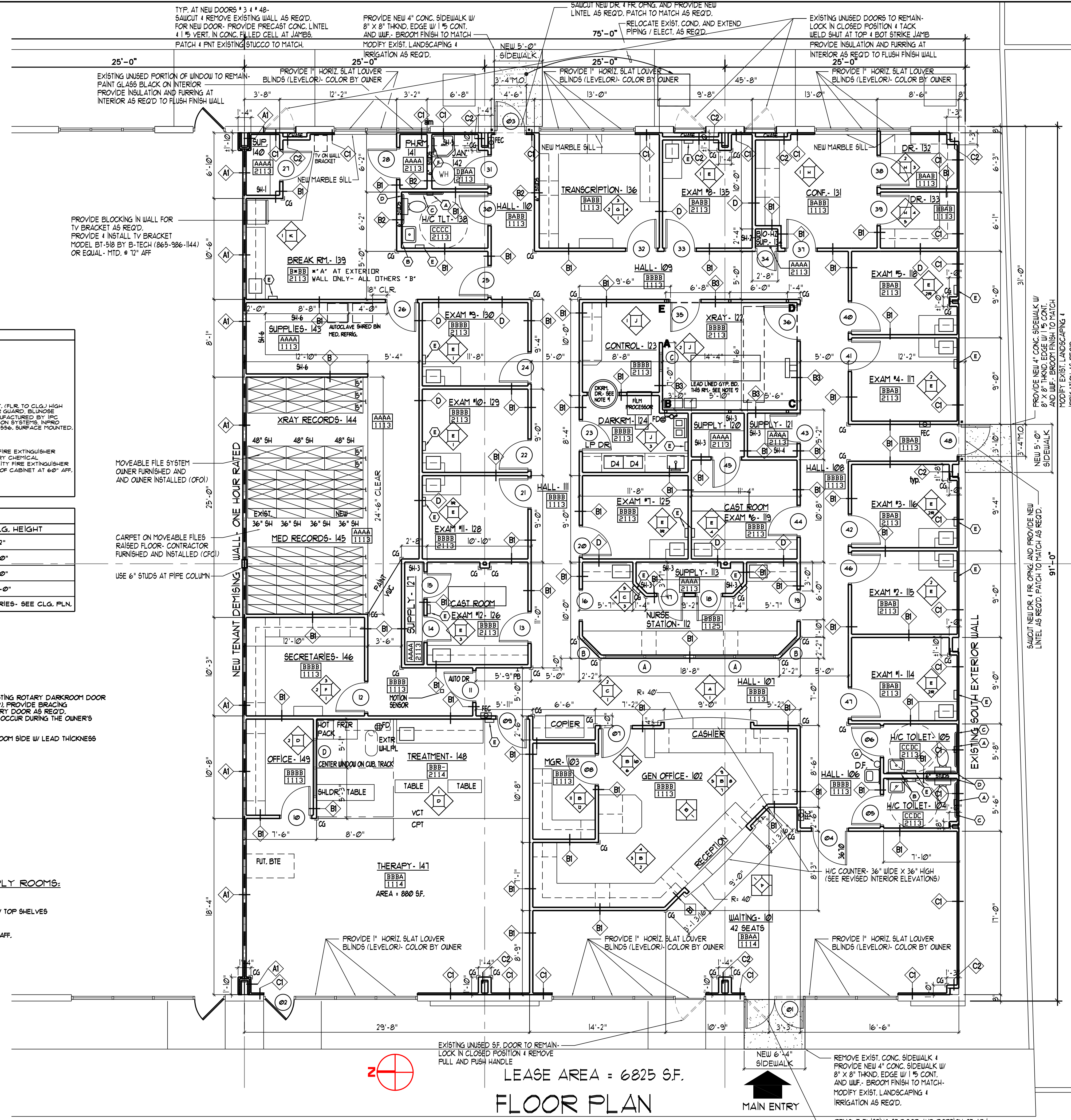

**SYMBOL LEGEND**

DOOR NUMBER - SEE DOOR SCHEDULE ON SHT. A-6	NEW DR. FRAME	REMOVE EXIST. DR. FRAME (UNDO)	EXIST. DR. FRAME TO REMAIN
FINISH WALL	FINISH WALL - WEST WALL	FINISH WALL - EAST WALL	FINISH WALL - SOUTH WALL
FINISH WALL - CLG. HT.	FINISH WALL - CLG. HT.	FINISH WALL - CLG. HT.	FINISH WALL - CLG. HT.
NEW PARTITIONS:	5/8" GYP. BD. ON METAL STUDS AT 24" O.C.	SEE PARTITION TYPES ON SHT. A-6	REMOVE EXIST. WALL OR PARTITION - PATCH WALLS, FLOOR & CLG. AS REQUIRED TO MATCH
EXIST. WALL OR PARTITION TO REMAIN	ONE HR. RATED PARTITION	NEW TENANT DEMISING WALL	NOTE: PROVIDE 6" HIGH PAINT STENCILED IDENTIFICATION READING: "ONE HOUR WALL - PROTECT ALL OPENINGS" AT 1" AFF AT 9" O.C. AND ABV. CEILING IN EACH SEPARATE ROOM.
TOILET ACCESSORIES - SEE SCHEDULE ON SHT. A-6	NEW 3" x 3" x 3/4" FULL HT. (FLR. TO CLG.) HIGH IMPACT RESISTANT CORNER GUARD - BLINDS MODEL 1808N (4 1/2" DIA.) MANUFACTURED BY IPC DOOR AND WALL PROTECTION SYSTEMS, INC. CORPORATION, 1520-227-9596, SURFACE MOUNTED.	FEC:	PROVIDE SEMI-RECESSED FIRE EXTINGUISHER CABINET AND UL LISTED DRY CHEMICAL TYPE 2 A-B-C, 5 LB. CAPACITY FIRE EXTINGUISHER WHERE SHOWN. MOUNT TOP OF CABINET AT 60" AFF.

**FINISH SCHEDULE**

WALLS	FLOOR	BASE	CEILING	CLG. HEIGHT
A PAINT	1 CARPET	1 4" VINYL / RUBBER	1 2x2 ACOUST. TILE / GRID	1 7'-2"
B VINYL WALL COVERING	2 VINYL COMP. TILE	2 4" VINYL / RUBBER	2 2x2 ACOUST. TILE / GRID - W/ FRT. DRYWALL SOFFIT - SEE CEILING PLAN	2 8'-0"
C 48" FRP WAINSCOT W/ VINYL WALL COVERING ABV.	3	3	3 DRYWALL - PAINT FINISH	3 9'-0"
D 48" FRP WAINSCOT W/ PAINT ABV.	4	4	4 VARIES - SEE CLG. PLN.	
E	5	5		

**FINISH SELECTIONS AND ALLOWANCES:**

**VINYL WALL COVERING ALLOWANCE:**  
 For vinyl material only: Allow + 16,000 per linear yard  
 - color(s) to be selected by Owner

**CARPET ALLOWANCE:**  
 For carpet material only: 28 oz. nylon Allow + 22,000 per square yard  
 - color(s) to be selected by Owner

**VCT FLOORING ALLOWANCE:**  
 For material only: Allow + 1,000 per square ft.  
 - color(s) to be selected by Owner

**VINYL / RUBBER BASE, 4" HIGH:**  
 - color(s) to be selected by Owner

**PAINTED INTERIOR WALLS:**  
 - color(s) to be selected by Owner

**ELASTIC LAMINATE FOR CABINETS:**  
 - color(s) to be selected by Owner

**DOORS AND FRAMES:**  
 HM Frames + Doors - Exterior - Paint Finish  
 - exterior color(s) to match existing building like components.  
 HM Frames - Interior - Paint Finish - color to be selected by Owner  
 Wd. Doors: Clear finish and sealer - rotary cut red oak wood species.

**ACOUSTIC TILE CEILINGS:**  
 2' x 2' Angled tegular edge acoustic tile and white ceiling grid  
 Armstrong Prelude 15/16" Exposed Tee System or equal  
 Armstrong Anled tegular Cirrus 584 or equal

**FRP Fiberglass Reinforced Panel w/ corner, 4 top wainscot trim as req'd.**  
 Color to be selected by Owner.

**EXTERIOR STUCCO AND TRIM:**  
 Texture + Paint Finish - to match existing building like components.

**PAINT SPEC:**  
 DRYWALL - WALLS AND CEILINGS:  
 1. EGGSHELL FINISH OPTION:  
 a. PRIMER: SHERWIN WILLIAMS PREP-RITE HI BUILD PRIMER  
 b. 2 FINISH COATS - SHERWIN WILLIAMS PROMAR 200 LATEX EGGSHELL  
 2. SEMI-GLOSS FINISH OPTION:  
 a. PRIMER: SHERWIN WILLIAMS PREP-RITE HI BUILD PRIMER  
 b. 2 FINISH COATS - SHERWIN WILLIAMS PROMAR 200 LATEX SEMI-GLOSS

**HM DOORS, FRAMES + WINDOWS:**  
 a. PRIMER: TOUCHUP SHOP PRIMER  
 b. 2 FINISH COATS - ICI DEVFLEX SEMI-GLOSS WATERBOURNE ENAMEL

**INTERIOR WOOD DOORS:**  
 a. STAIN COAT: SHERWIN WILLIAMS WOOD CLASSICS SEMI-TRANSPARENT STAIN  
 b. SEALER: SHERWIN WILLIAMS WOOD CLASSICS SANDING SEALER  
 c. 2nd + 3rd FINISH COATS - SHERWIN WILLIAMS WOOD CLASSICS SATIN FINISH POLYURETHANE

**WOOD DOOR FRAMES + WOOD WINDOW FRAMES (NOT USED):**  
 a. PRIMER: ICI 1020 PREP + PRIME ALKYD WOOD UNDERCOAT  
 b. 2 FINISH COATS - ICI DEVFLEX SEMI-GLOSS WATERBOURNE ENAMEL

**NOTE: REFER TO GE WALKER DRAWINGS FOR X-RAY EQUIP. AND RESPONSIBILITIES.**

**DARKROOM EQUIPMENT NOTES:**  
 NOTE 1: GEN. CONTR. TO REMOVE AND RELOCATE EXISTING ROTARY DARKROOM DOOR FROM THE EXISTING UCF OFFICE (SEE LOCATION MAP). PROVIDE BRACING AND BLOCKING TO SUPPORT THE RELOCATED ROTARY DOOR AS REQ'D. THIS RELOCATION AND INSTALLATION WILL NEED TO OCCUR DURING THE OWNER'S MOVE-IN WEEKEND.

**NOTE 2: PROVIDE LEAD LINED GYP. BD. ON X-RAY ROOM SIDE W/ LEAD THICKNESS PER THE SCHEDULE BELOW.**

**LEAD LINING THICKNESS REQUIREMENTS (FROM GE WALKER REPORT):**

A TO B :	1/32" THK.
B TO C :	1/32" THK.
C TO D :	1/16" THK.
D TO E :	1/32" THK.
E TO A :	NONE REQ'D.

**FIXED SHELVING LEGEND @ SUPPLY ROOMS:**  
 (SEE DETAIL L / A-5)

SH-1: 30" DEEP / W/ BOT. / 4 ADJ. / TOP SHELVES  
 SH-2: 22" DEEP / W/ BOTTOM SHELF AT 36" AFF / 1 ADJ. / TOP SHELVES  
 SH-3: 22" DEEP / W/ BOT. / 4 ADJ. / TOP SHELVES  
 SH-4: 16" DEEP / W/ BOT. / 4 ADJ. / TOP SHELVES  
 SH-5: (JAN. 142) 14" DEEP FIXED SINGLE SHELF AT 12" AFF.  
 SH-6: 24" DEEP / W/ BOT. / 4 ADJ. / TOP SHELVES

LEASE AREA = 6825 SF.  
**FLOOR PLAN**  
 SCALE: 3/16" = 1'-0"